

TA-500 Battery Pack Kit User Manual



Package Contents

- ✓ TA-500 Battery Kit.....(x 1)
- ✓ RB-3000 Battery Pack..... (x 1)
- ✓ Stylus.....(x 1)
- ✓ Neck/Shoulder Strap.....(x 1)
- ✓ Fixing screw.....(x 1)
- ✓ User manual.....(x 1)



Views of TA-500

Front View

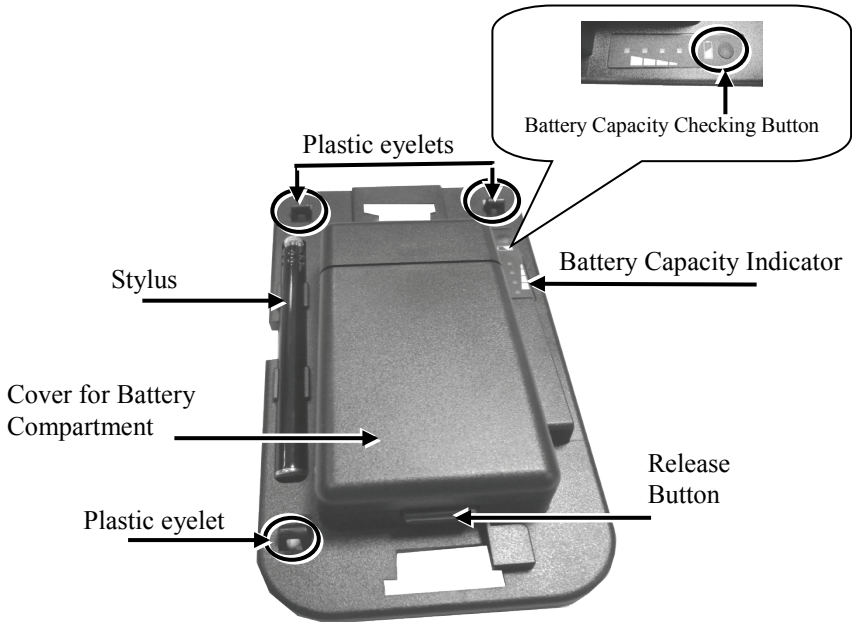

Mounting TA-500 onto MT-series Tablet

TA-500 is an external battery pack kit mainly designed to provide extra battery life to MT-series tablet. Please follow the steps described below to finish the installation.

1. Lay MT-series with its screen on a flat surface.
2. Release the hand strap or pistol grip from MT series tablet.
 - 2.1. To remove the hand strap cover from MT-series tablet, first loosen the screw to remove the hand strap cover from the tablet. Next, Slide the hand strap cover down in the direction indicated by the arrow.

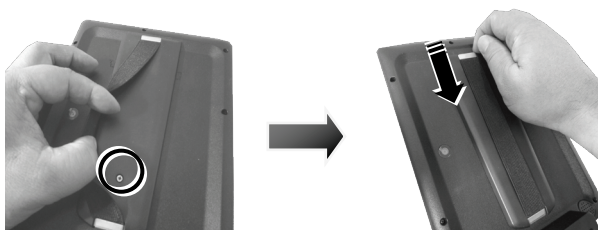

- 2.2. To remove the grip pistol from MT-series tablet, after pushing the release lever to the left (1), slide the pistol grip in the direction indicated by the arrow in the figure (2). Then, pull the pistol grip off from the tablet. (3)

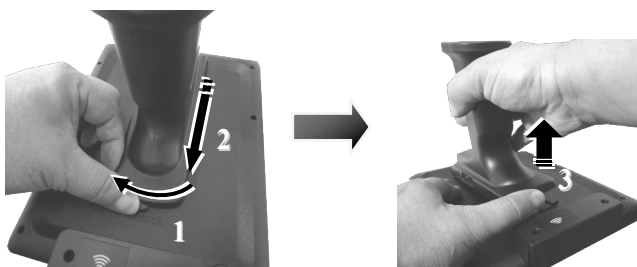

3. Take TA-500, push down the release button to slide the cover off the battery compartment.



4. Locate the arrow mark on the rear of MT series. Slide TA-500 all the way in the direction shown by the arrow until the battery pack kit is locked in place.

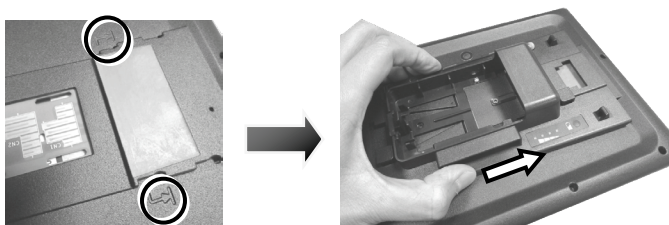

5. Insert one fixing screw into the screw hole and fasten the screw to fix TA-500 to MT-series tablet.

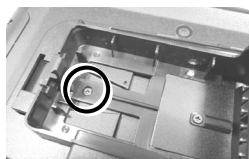

6. Take out the battery out of the package box. First locate the contacts on the battery. Then, after attaching the battery contacts to the contacts inside the battery compartment and having the side with the slot face down, slide the battery down into the compartment.

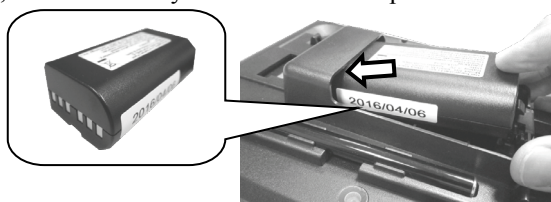

7. If you attempt to remove the battery from the battery compartment, first push the battery inwards (1) and lift it up out of the compartment (2).



8. Make sure whether the battery pack kit is properly inserted in the compartment.



9. After ensuring the battery is well inserted in the compartment, push back the cover to close the battery compartment.

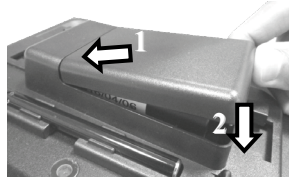

Using the Stylus with MT-series Tablet

To enhance your experience of using MT-series tablet, a stylus is offered to assist you in operating MT-series tablet without getting the screen scratched easily.

As the figure shows, the stylus is located at the left side of TA-500. To start with the stylus, please grab the stylus with your fingers and pull it out forcefully to release it from TA-500.

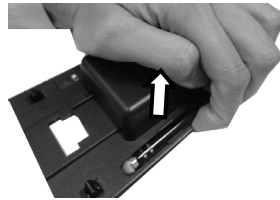

Using Neck/Shoulder Strap for MT-series Tablet

With adjustable neck/shoulder strap, users are able to carry MT-series tablet with TA-500 battery pack kit around more comfortably. Please refer to the instruction below to attach the strap to TA-500.

Grab both ends of the strap and snap the strap clip into the plastic eyelets as shown in the figure depending on your preference.

You may attach the strap either horizontally or vertically depending on your preference.



Charging Battery Pack of TA-500

Below are some cautionary advices you need to keep in mind while you attempt to charge the battery.

1. **Make sure TA-500 has been fully charged. To do so, keep the battery pack kit charged until a set of four LEDs all stay on. When battery capacity indicator shows low battery capacity, please charge the battery pack RB-3000 or the battery pack kit TA-500 immediately.**
2. **Once TA-500 has been mounted onto MT-series tablet, battery capacity indicator will automatically show the current battery status, and the charging procedure for tablet will be initiated via the battery pack.**
3. **If the battery pack is not fully charged, charge the battery with the standard power adapter provided with MT-series tablet. Using a different power adapter may damage your device.**
4. **Please refer to MT-series user manual for details about how to charge your battery.**
5. **Within TA-500 battery pack, the optional backup battery RB-3000 can be purchased individually. It is normally encouraged to get a backup battery, especially in case of a long-time operation or unexpected power outage. Also, to charge multiple RB-3000 backup batteries more efficiently, CS-100 battery charger is available to help you achieve the purpose.**

Battery Capacity Indicator

Battery capacity indicator, which is composed of a set of four LEDs and a button, is provided to remind users of the current battery charge status.

Besides, as shown in the figure, battery capacity checking button could function differently in different occasions. Below are the descriptions regarding how it works with/without MT-series tablet:

- While TA-500 is mounted to MT-Series tablet, push the button to check the current battery capacity and to initiate the charging process for the battery pack RB-3000.
- In the case that TA-500 is not installed onto the tablet, pushing the button will show the current battery status of TA-500.

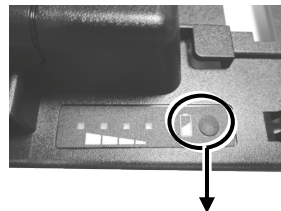

Battery Capacity Checking Button

<MEMO>

<MEMO>

<MEMO>